

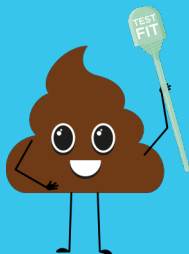

## I COMPLETE MY TEST IN 3 STEPS

- 1** I read the instructions  
> Section 1 of the kit
- 2** I fill out the identification form  
> Section 2 of the kit
- 3** I perform the test and submit it to a BIONEXT laboratory or a Post mailbox  
> Section 3 of the kit





Instructions for use

## KEY INFOS

Colorectal cancer screening tests can detect cancer at a very early stage.

It is recommended every 2 years for women and men aged from 45 to 74 with no symptoms or history of the disease.

**Detected early, this cancer can be cured in 9 out of 10 cases.**

-  **Reliable**
-  **Covered by 100%**
-  **Quick and easy**

### Frequently asked questions

#### How long does the test last?

The expiry date is indicated on the tube

#### I've lost the tube or it's damaged. What should I do?

Ask the BIONEXT laboratory or your pharmacist for a new kit

#### The sample was not taken correctly. What should I do?

Ask the BIONEXT laboratory or a pharmacist for advice

#### Do I have to pay for this test?

No, it is 100% covered by the Department of health

#### Can I take the blue envelope with my sample to another laboratory?

No, you must deliver it to a Post letterbox (the return envelope is pre-stamped) or to the BIONEXT laboratory of your choice.

#### Who will receive my result?

You, the doctor you have designated on your identification form, and the doctor at the cancer screening programme coordination centre

## COLORECTAL CANCER SCREENING KIT

## INSTRUCTIONS FOR USE

**This kit is for personal use only**

**Before use, store the kit at a temperature between +2°C and +30°C**

### Contact

Centre de coordination des programmes de dépistage des cancers,  
Ministère de la Santé et de la Sécurité sociale, Direction de la santé  
20, rue de Bitbourg - L-1273 Luxembourg-Hamm  
Tél. : 247 755 50 - Fax : 247 95563 - colorectal@ms.etat.lu - www.sante.lu



D\_COMM\_190\_001

# INSTRUCTIONS FOR USE

## Before starting

Check the expiration date of the test on the envelope or on the tube.

If the test is expired, request a new one by contacting the BIONEXT laboratory at (+352) 27 321 888

## I RECEIVED MY KIT AT A BIONEXT LABORATORY

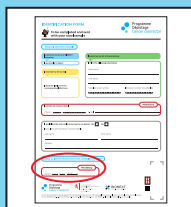

I take the identification form and write down the **test completion date**

## I RECEIVED MY KIT BY MAIL

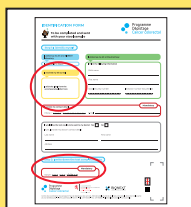

I take the identification form, stick on the **name label**, and write the **test completion date**

## I PICKED UP MY KIT AT THE PHARMACY

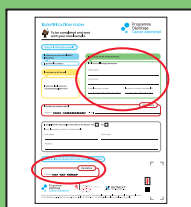

I take the identification form, fill in the information, and write the **test completion date**

# I PERFORM MY TEST



1

**Urinate before starting your test.**  
The stool should not come into contact with any liquids (urine, bleach, etc.)



2

**Attach the brown stool collection paper** from Section 2 to the toilet seat using the stickers. Gently press the paper to create a small depression. Then, place the stool in the depression

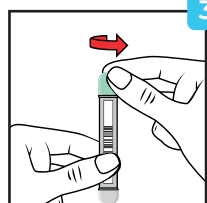

3

Open the tube by turning the green cap

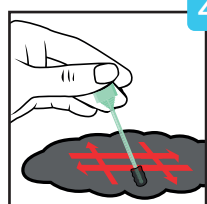

4

**Scrape the surface of the stool at several places** using the green stick, then flush the brown paper down the toilet

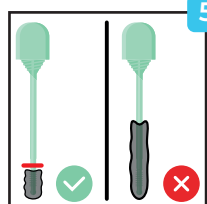

5

The striped part of the stick (up to the red mark on the drawing) **must be covered with stool**

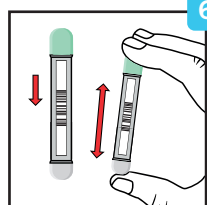

6

**Close the tube and shake it vigorously**



7

Then, slide the tube into the protective bag (**Safetybag**) from Section 3



8

Seal the Safetybag by removing the **white tab at the top of the bag**

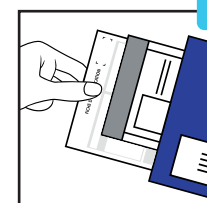

9

Insert the Safetybag and the **dated and completed** identification form in the pre-paid blue return envelope of section 3

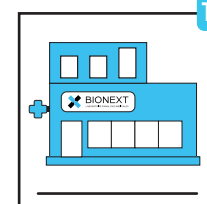

10

**Return the blue envelope on the same day or, at the latest, the next day, either**

- by delivering it directly to a **BIONEXT laboratory** from Monday to Saturday.

List of laboratories: [bionext.lu/centres](http://bionext.lu/centres)

- by dropping it in a **Post mailbox** (except on the day before a weekend or public holiday)

## More information

- Laboratory BIONEXT : (+352) 27 321 888
- At your pharmacy
- Centre de coordination des programmes de dépistage des cancers [www.sante.lu/colorectal](http://www.sante.lu/colorectal) or by phone at (+352) 247-75550